

The design of Power Connection Systems Series connectors allows for the development of application specific contact arrangements in a timely manner and at a reasonable price. Thirteen connector housing sizes exist that may accommodate size 20, size 16, size 12, or size 8 contacts (see the Power Connection Systems catalog for connector housing dimensions). After reviewing the dimensions and the following basic information, contact Technical Sales with your current, voltage, and safety requirements. We look forward to working with you to develop a connector for your specific needs.

BASIC CONNECTOR DIMENSIONS

Male Connector Dimensions

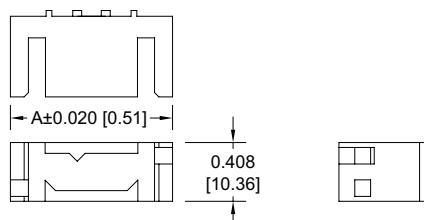

| PART NUMBER | A |
|-----------------------------|------------------|
| PLA03**00A1 PLAH03**00A1 | 1.126 [28.60] |
| PLA04**00A1 PLAH04**00A1 | 1.324 [33.63] |
| PLA06**00A1 PLAH06**00A1 | 1.718 [43.64] |
| PLA08**00A1 PLAH08**00A1 | 2.112 [53.64] |

Female Connector Dimensions

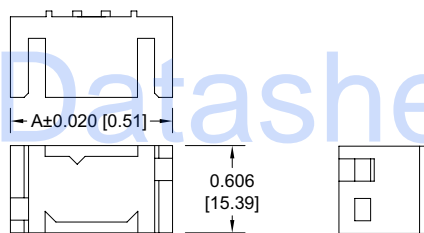
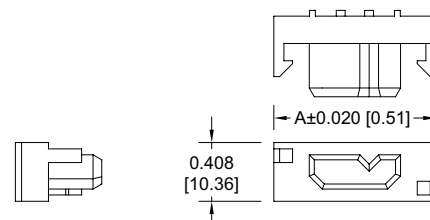

| PART NUMBER | A |
|-----------------------------|------------------|
| PLB06**00A1 PLBH06**00A1 | 1.126 [28.60] |
| PLB08**00A1 PLBH08**00A1 | 1.324 [33.63] |
| PLB12**00A1 PLBH12**00A1 | 1.718 [43.64] |
| PLB16**00A1 PLBH16**00A1 | 2.112 [53.64] |
| PLB20**00A1 PLBH20**00A1 | 2.506 [63.65] |

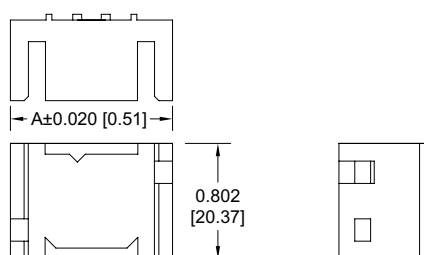
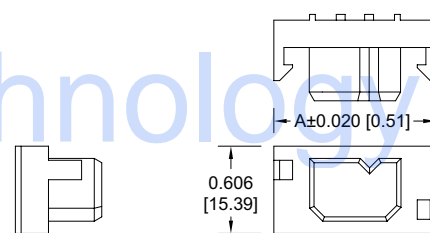

| PART NUMBER | A |
|-----------------------------|------------------|
| PLC09**00A1 PLCH09**00A1 | 1.126 [28.60] |
| PLC12**00A1 PLCH12**00A1 | 1.324 [33.63] |
| PLC18**00A1 PLCH18**00A1 | 1.718 [43.64] |
| PLC24**00A1 PLCH24**00A1 | 2.112 [53.64] |
| PLC30**00A1 PLCH30**00A1 | 2.506 [63.65] |

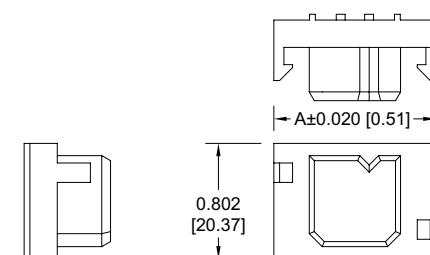

Four Contact Sizes to Choose From

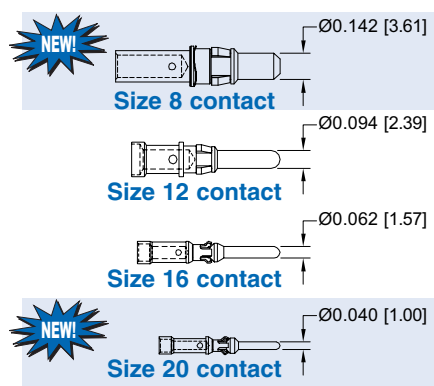

Many Termination Types Can Be Supplied

Straight Solder or Press-Fit
Right Angle (90°) Solder
Crimp Removable
Removable Solder Cup

Popular Options

Sequential Mating
Selective Loading

Contact sizes and termination types may be mixed within a single connector.



TECHNICAL CHARACTERISTICS

MATERIALS AND FINISHES:

| | |
|--------------------------|--|
| Insulator: | Glass-filled polyester, UL 94V-0. Contact technical sales for availability of high temperature insulator material. |
| Contacts: | Precision machined copper alloy with gold flash over nickel, or 0.000030 inch [0.76µ] gold over nickel, or 0.000050 [1.27µ] gold over nickel. Solder coated terminations optional. |
| Mounting Clip: | Beryllium copper with nickel plate. |
| Hood: | Glass filled polyester, UL 94V-0. |
| Mounting Bracket: | Brass with tin plate. |
| Push-on Fastener: | Spring tempered copper alloy, tin plate |

ELECTRICAL CHARACTERISTICS:

CONTACT CURRENT RATING:

| | |
|--|------------------------------------|
| Standard Contact Material: | See page 9 for detail information. |
| High Conductivity Contact Material: | See page 9 for detail information. |

INITIAL CONTACT RESISTANCE:

| | |
|--|---|
| Standard Contact Material: | 0.0016 ohms max. per IEC 512-2, Test 2b. |
| High Conductivity Contact Material: | 0.0007 ohms max. per IEC 512-2, Test 2b. |
| Insulation Resistance: | 5 G ohms per IEC 512-2, Test 3a, Method A. |
| Voltage Proof: | 2000 V rms per IEC 512-2, Test 4a, Method C. |
| Creepage Distance: | 0.157 inch [4 mm] minimum. |
| Clearance Distance: | 0.125 inch [3.2 mm] minimum. |
| Working Voltage: | Designed to meet UL 600 VAC and CSA 600 VAC. |
| Working Temperature: | -55°C to +125°C Contact technical sales for availability of high temperature insulator material. |

ELECTRICAL CHARACTERISTICS OF COMPLIANT PRESS-FIT CONNECTION TO PLATED-THROUGH-HOLE OF PRINTED BOARD:

| | |
|---|--|
| | 0.064 inch [1.63mm] diameter hole of a 0.125 inch [3.2mm] thick printed board |
| Initial Contact Resistance of Connection: | Less than 1.0 milliohms per IEC 512-2, Test 2a. |
| Change in Contact Resistance of Connection After Mechanical, Electrical or Climactic Conditioning: | Less than 0.5 milliohms increase per IEC 512-2, Test 2a. |
| Gas Tight Connections Test: | Less than 0.2 milliohms increase in contact resistance after 1 hour per EIA 364, TP36, Method One. |

SHIELDED CONTACT TECHNICAL CHARACTERISTICS:

See page 47.



For RoHS options see page 26.

MECHANICAL CHARACTERISTICS:

| | |
|--|---|
| Removable Contacts: | Insert contact to rear face of insulator, release from front face of insulator. Size 16, 0.062 inch [1.57 mm] diameter male contact. Female contact "closed entry" design for highest reliability. |
| Removable Contact Retention in Insulator: | 15 lbs. [67N] per IEC 512-8, Test 15a. |
| Fixed Contacts: | Solder cup and printed board terminations. Size 16, 0.062 inch [1.57 mm] diameter male contact. Female contact has "closed entry" design for highest reliability. |
| Fixed Contact Retention in Insulator: | 6 lbs. [26N]. |
| Resistance to Solder Iron Heat: | 500°F [260°C] for 10 seconds duration per IEC 512-6, Test 12e, 25 watt soldering iron. |
| Contact Terminations: | Crimp or solder removable contacts from wire sizes 12 AWG [4.0 mm ²] through 24 AWG [0.25 mm ²]. Straight and Right Angle (90°) solder printed board mount, 0.062 inch [1.57 mm] tail diameter. Compliant termination press-fit. Fixed contact solder cup termination, 18 AWG [1.0 mm ²] maximum. |
| Contact Insertion and Withdrawal Forces: | 8 oz. [2.2N] nominal per contact. |
| Connection Systems: | Connector provides cable to cable, cable to printed board, cable to panel mount and printed board to printed board application. |
| Sequential Mating System: | Cable and printed board mount connectors. Male contacts provide as many as three mating lengths. |
| Locking System: | Insulators provide locking between cable to cable, cable to printed board and cable to panel mount applications. |
| Polarizations: | Provided in insulator design. Further polarization in cable connectors can be provided by mixing male contacts in female insulators and female contacts in male insulators. |
| Mounting to Printed Board: | Rapid installation push-on fasteners. Self-tapping screws for compliant connectors. 500 operations per IEC 512-5. |
| Mechanical Operations: | |

MECHANICAL CHARACTERISTICS OF COMPLIANT PRESS-FIT CONNECTORS:

| | |
|---|--|
| Press-Fit Contact Bi-Spring Construction, Compliant Termination: | 0.0695 inch [1.77mm] diameter with 0.050 inch [1.27mm] lead-in diameter. Offered with two termination lengths. |
| Contact Retention in Insulator and 0.125 inch [3.2mm] thick printed board: | 5 lbs. [22N] minimum combined retention forces per MIL-STD-2166, Type III compliant contact classification, after third repair- replacement of contact in insulator and plated-through-hole, 0.064 inch [1.63mm] diameter in a 0.125 inch [3.2mm] thick printed board. |
| Vibration: | No electrical discontinuity of 1µ second or greater when tested per MIL-STD-1344, Method 2005, Test conditioning. |
| Initial Press-In Force of Individual Contact into Plated-Through-Hole: | 10 lbs. [44N] average when pushed into a 0.064 inch [1.63mm] Ø hole in a 0.125 inch [3.2mm] thick printed board. |
| Initial Push-Out Force of Individual Contact into Plated-Through-Hole: | 8.5 lbs. [38N] average when pushed out of an 0.064 inch [1.63mm] Ø hole in a 0.125 inch [3.2mm] thick printed board. |

U.L. Recognized*
File #E49351

CSA Recognized
File #LR54219

*Note: U.L. Recognized all sizes, except PLB20, consult Technical Sales for status.

TEMPERATURE RISE CURVE

STANDARD CONTACT MATERIALS

CONNECTORS WITH PL* PREFIX

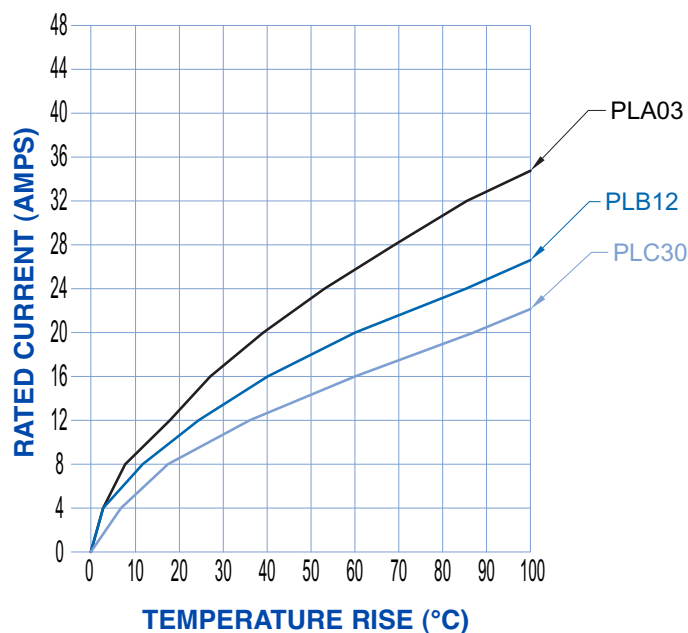

HIGH CONDUCTIVITY CONTACT MATERIALS

CONNECTORS WITH PL*H PREFIX
OR "S" SUFFIX ON CRIMP CONTACTS

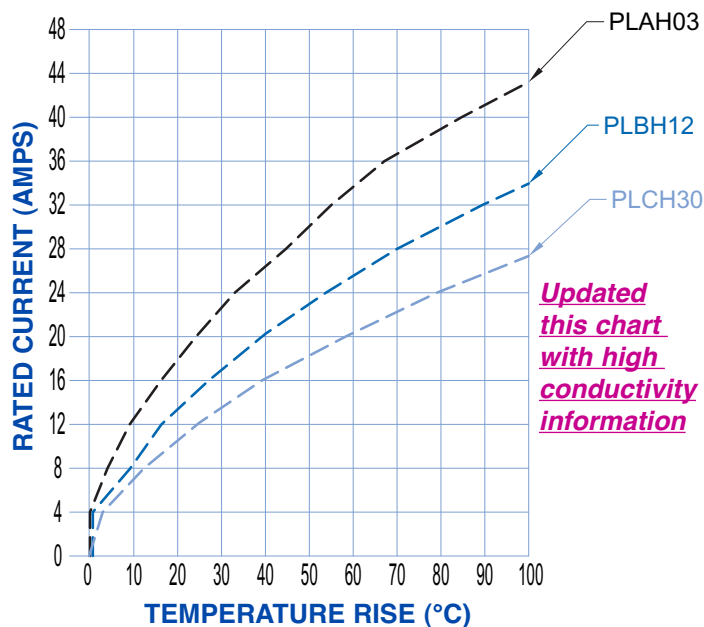

TEST DETAIL: Each curve was developed using individual connector bodies fully loaded with contacts. All power contacts energized through 12 awg wire. Temperature rise was measured in the contact mating area. Test was conducted with connectors in static air. Terminations of test connectors were straight compliant press-fit to right angle (90°) solder. See page 4 for more information.

| CONTACT CURRENT RATINGS | | | |
|-------------------------|-------------------|-------------------|----------------------------|
| CONNECTOR VARIANT | STANDARD CONTACTS | CONNECTOR VARIANT | HIGH CONDUCTIVITY CONTACTS |
| PLA03 | 32 amps | PLAH03 | 42 amps |
| PLB12 | 25 amps | PLBH12 | 32 amps |
| PLC30 | 18 amps | PLCH30 | 24 amp |

Temperature rise curves and contact current ratings were developed for the specific connector variants shown when tested in accordance with UL1977.

This information is provided so that the user can make comparisons between various connector sizes and contact materials.



MATING DIMENSIONS (FULLY MATED)

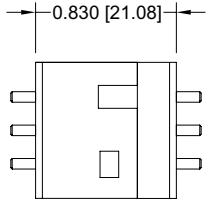

**Straight Board Mount Male
to Straight Board Mount
Female**

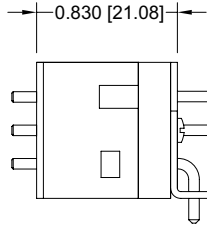

**Straight Board Mount Male
to Right Angle (90°) Board
Mount Female**

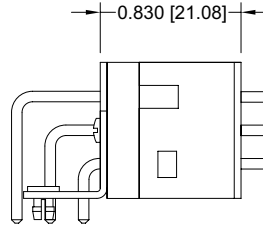

**Right Angle (90°) Board
Mount Male to Straight
Board Mount Female**

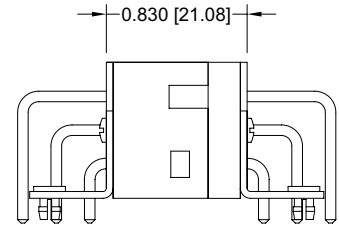

**Right Angle (90°) Board
Mount Male to Right Angle
(90°) Board Mount Female**

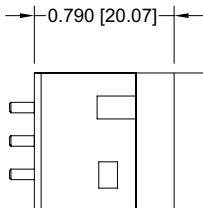

**Straight Board Mount Male
to Panel Mount
Female**

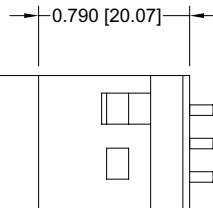

**Panel Mount Male
to Straight Board
Mount Female**

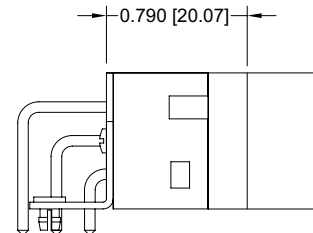

**Right Angle (90°) Board
Mount Male to Panel
Board Mount Female**

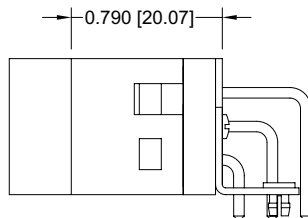

**Panel Mount Male
to Right Angle (90°) Board
Mount Female**

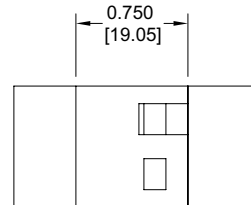

**Panel Mount Male
to Panel Mount
Female**

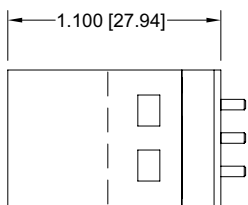

**Cable Mount Male
to Straight Board
Mount Female**

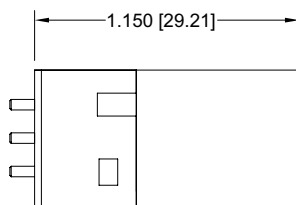

**Straight Board Mount
Male to Cable
Mount Female**

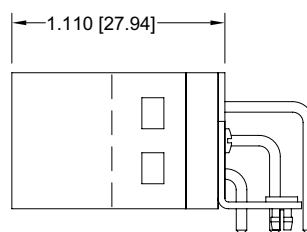

**Cable Mount Male
to Right Angle (90°)
Board Mount Female**

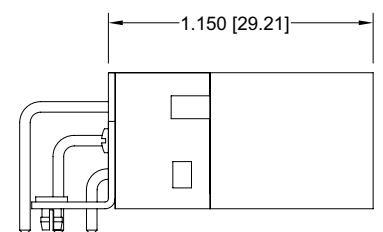

**Right Angle (90°) Board Mount
Male to Cable Mount
Female**

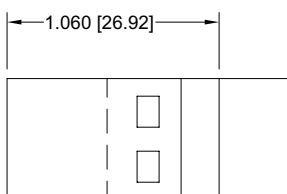

**Cable Mount Male
to
Panel Mount Female**

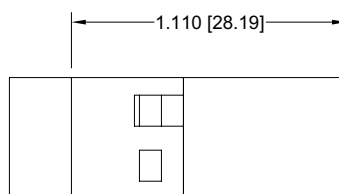

**Panel Mount Male
to Cable Mount
Female**

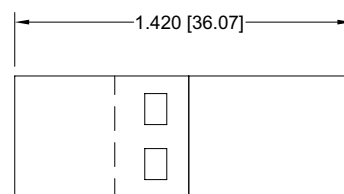

**Cable Mount Male
to
Cable Mount Female**

PLA STRAIGHT PRINTED BOARD MOUNT CONNECTORS CODE 3, 0.146 [3.71] CONTACT EXTENSION

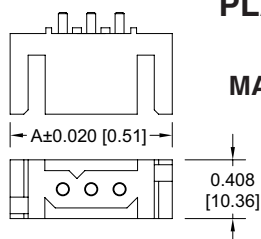

Typical part number:
PLA03M300A1
PLAH03M300A1

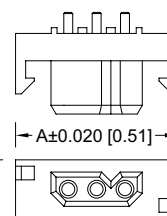
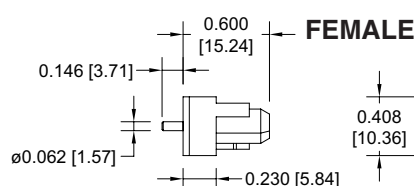
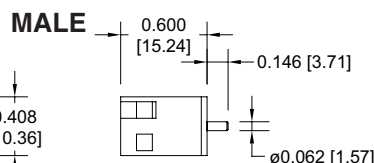

Typical part number:
PLA03F300A1
PLAH03F300A1

*Asterisk determines
gender of connector,
M for male,
F for female.

| PART NUMBER | A | PART NUMBER | A |
|-----------------------------|------------------|-----------------------------|------------------|
| PLA03*300A1 PLAH03*300A1 | 1.126 [28.60] | PLA06*300A1 PLAH06*300A1 | 1.718 [43.64] |
| PLA04*300A1 PLAH04*300A1 | 1.324 [33.63] | PLA08*300A1 PLAH08*300A1 | 2.112 [53.64] |

Plating- See ordering information
for contact plating options.

For connection systems 1, 4 and 6.

PLB STRAIGHT PRINTED BOARD MOUNT CONNECTORS CODE 3, 0.146 [3.71] CONTACT EXTENSION

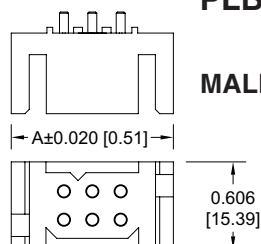

Typical part number:
PLB06M300A1
PLBH06M300A1

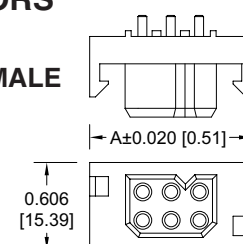
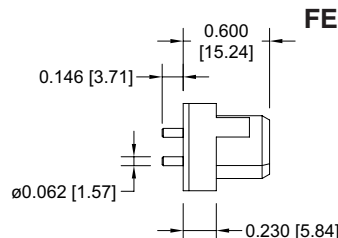
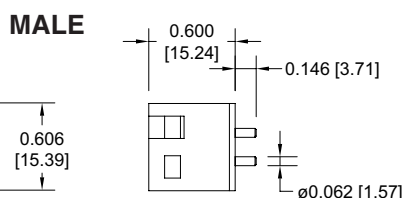

Typical part number:
PLB06F300A1
PLAH06F300A1

*Asterisk determines
gender of connector,
M for male,
F for female.

| PART NUMBER | A | PART NUMBER | A |
|-----------------------------|------------------|-----------------------------|------------------|
| PLB06*300A1 PLBH06*300A1 | 1.126 [28.60] | PLB16*300A1 PLBH16*300A1 | 2.112 [53.64] |
| PLB08*300A1 PLBH08*300A1 | 1.324 [33.63] | PLB20*300A1 PLBH20*300A1 | 2.506 [63.65] |
| PLB12*300A1 PLBH12*300A1 | 1.718 [43.64] | | |

Plating- See ordering information
for contact plating options.

For connection systems 1, 4 and 6.

PLC STRAIGHT PRINTED BOARD MOUNT CONNECTORS CODE 3, 0.146 [3.71] CONTACT EXTENSION

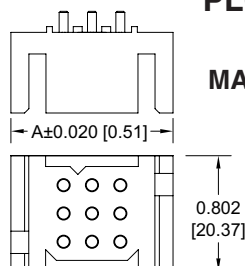

Typical part number:
PLC09M300A1
PLCH09M300A1

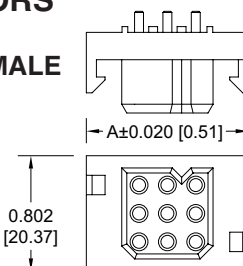
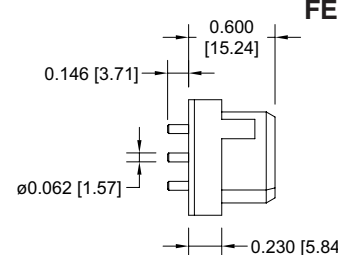
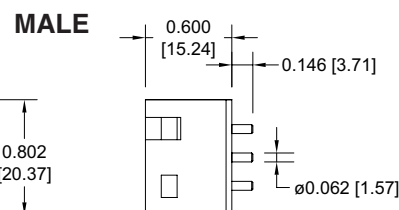

Typical part number:
PLC09F300A1
PLCH09F300A1

*Asterisk determines
gender of connector,
M for male,
F for female.

| PART NUMBER | A | PART NUMBER | A |
|-----------------------------|------------------|-----------------------------|------------------|
| PLC09*300A1 PLCH09*300A1 | 1.126 [28.60] | PLC24*300A1 PLCH24*300A1 | 2.112 [53.64] |
| PLC12*300A1 PLCH12*300A1 | 1.324 [33.63] | PLC30*300A1 PLCH30*300A1 | 2.506 [63.65] |
| PLC18*300A1 PLCH18*300A1 | 1.718 [43.64] | | |

Plating- See ordering information
for contact plating options.

For connection systems 1, 4 and 6.



Positronic Industries
connectpositronic.com

STRAIGHT SOLDER PRINTED BOARD CONNECTOR

Power
Connection
Systems

PLA STRAIGHT PRINTED BOARD MOUNT CONNECTORS CODE 32, 0.377 [9.58] CONTACT EXTENSION

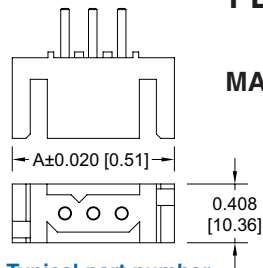

MALE

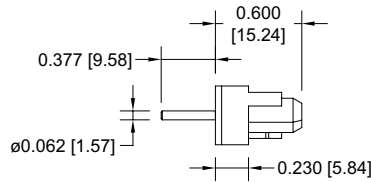
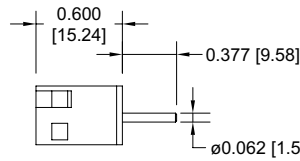

FEMALE

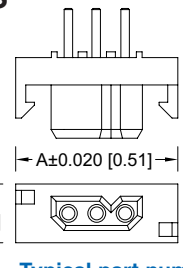

Typical part number:
PLA03M3200A1
PLAH03M3200A1

Typical part number:
PLA03F3200A1
PLAH03F3200A1

*Asterisk determines
gender of connector,
M for male,
F for female.

| PART NUMBER | A | PART NUMBER | A |
|---------------|------------------|---------------|------------------|
| PLA03*3200A1 | 1.126 [28.60] | PLA06*3200A1 | 1.718 [43.64] |
| PLAH03*3200A1 | | PLAH06*3200A1 | |
| PLA04*3200A1 | 1.324 [33.63] | PLA08*3200A1 | 2.112 [53.64] |
| PLAH04*3200A1 | | PLAH08*3200A1 | |

Plating- See ordering information
for contact plating options.

For connection systems 1, 3, 4 and 6.

PLB STRAIGHT PRINTED BOARD MOUNT CONNECTORS CODE 32, 0.377 [9.58] CONTACT EXTENSION

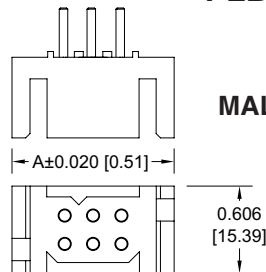

MALE

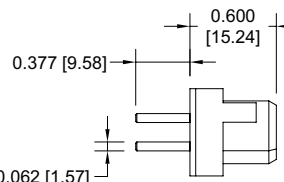
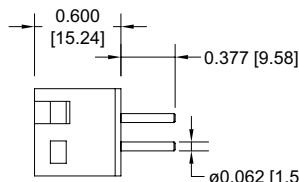

FEMALE

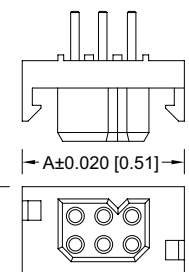

Typical part number:
PLB06M3200A1
PLBH06M3200A1

Typical part number:
PLB06F3200A1
PLBH06F3200A1

*Asterisk determines
gender of connector,
M for male,
F for female.

| PART NUMBER | A | PART NUMBER | A |
|---------------|------------------|---------------|------------------|
| PLB06*3200A1 | 1.126 [28.60] | PLB16*3200A1 | 2.112 [53.64] |
| PLBH06*3200A1 | | PLBH16*3200A1 | |
| PLB08*3200A1 | 1.324 [33.63] | PLB20*3200A1 | 2.506 [63.65] |
| PLBH08*3200A1 | | PLBH20*3200A1 | |
| PLB12*3200A1 | 1.718 [43.64] | | |
| PLBH12*3200A1 | | | |

Plating- See ordering information
for contact plating options.

For connection systems 1, 3, 4 and 6.

PLC STRAIGHT PRINTED BOARD MOUNT CONNECTORS CODE 32, 0.377 [9.58] CONTACT EXTENSION

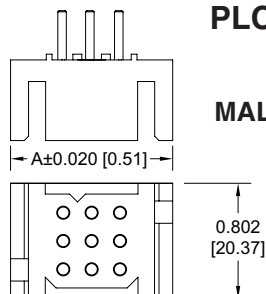

MALE

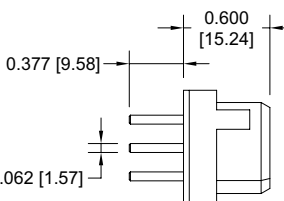
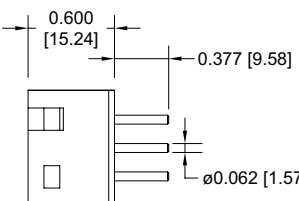

FEMALE

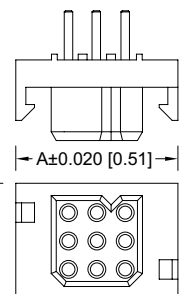

Typical part number:
PLC09M3200A1
PLCH09M3200A1

Typical part number:
PLC09F3200A1
PLCH09F3200A1

*Asterisk determines
gender of connector,
M for male,
F for female.

| PART NUMBER | A | PART NUMBER | A |
|---------------|------------------|---------------|------------------|
| PLC09*3200A1 | 1.126 [28.60] | PLC24*3200A1 | 2.112 [53.64] |
| PLCH09*3200A1 | | PLCH24*3200A1 | |
| PLC12*3200A1 | 1.324 [33.63] | PLC30*3200A1 | 2.506 [63.65] |
| PLCH12*3200A1 | | PLCH30*3200A1 | |
| PLC18*3200A1 | 1.718 [43.64] | | |
| PLCH18*3200A1 | | | |

Plating- See ordering information
for contact plating options.

For connection systems 1, 3, 4 and 6.

PLA COMPLIANT PRESS-FIT CONNECTORS

CODE 92 OR CODE 93

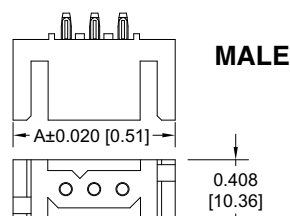

MALE

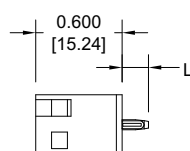

Typical part number:
PLA03M93ST30A1
PLAH03M93ST30A1

**Asterisks determine
gender of connector,
M for male,
F for female and
contact code 92 or 93.

| PART NUMBER | A |
|-----------------------------|------------------|
| PLA03**00A1 PLAH03**00A1 | 1.126 [28.60] |
| PLA04**00A1 PLAH04**00A1 | 1.324 [33.63] |
| PLA06**00A1 PLAH06**00A1 | 1.718 [43.64] |
| PLA08**00A1 PLAH08**00A1 | 2.112 [53.64] |

See page 60
for Installation Tooling.

Plating- See ordering information for
contact plating options.

For connection systems 1,4 and 6.

** MOUNTING SCREWS CAN BE SUP-
PLIED WITH CONNECTORS USING
STEP 5 IN ORDERING INFORMATION
ON PAGE 26. MOUNTING SCREWS
CAN ALSO BE ORDERED SEPARATELY
BY PART NUMBER. SEE PAGE 63.*

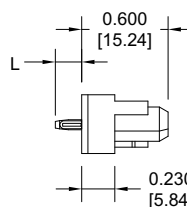

FEMALE

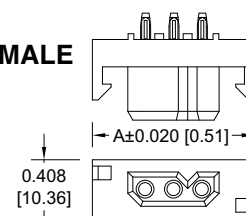

Typical part number:
PLA03F93ST30A1
PLAH03F93ST30A1

| CONTACT CODE | L | PCB THICKNESS | SCREW CODE * |
|--------------|-----------------|-----------------|--------------------------|
| 92 | 0.183 [4.65] | 0.093 [2.36] | ST2 SS2 ST3 SS3 |
| 93 | 0.218 [5.54] | 0.125 [3.18] | ST4 SS4 |

NEW!

PLB COMPLIANT PRESS-FIT CONNECTORS

CODE 92 OR CODE 93

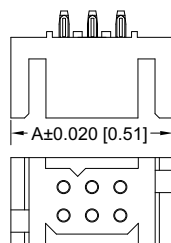

MALE

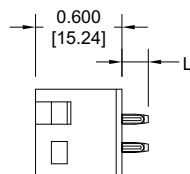

Typical part number:
PLB06M93ST30A1
PLBH06M93ST30A1

**Asterisks determine
gender of connector,
M for male,
F for female and
contact code 92 or 93.

| PART NUMBER | A |
|-----------------------------|------------------|
| PLB06**00A1 PLBH06**00A1 | 1.126 [28.60] |
| PLB08**00A1 PLBH08**00A1 | 1.324 [33.63] |
| PLB12**00A1 PLBH12**00A1 | 1.718 [43.64] |
| PLB16**00A1 PLBH16**00A1 | 2.112 [53.64] |
| PLB20**00A1 PLBH20**00A1 | 2.506 [63.65] |

See page 60
for Installation Tooling.

Plating- See ordering information for
contact plating options.

For connection systems 1,4 and 6.

** MOUNTING SCREWS CAN BE SUP-
PLIED WITH CONNECTORS USING
STEP 5 IN ORDERING INFORMATION
ON PAGE 26. MOUNTING SCREWS
CAN ALSO BE ORDERED SEPARATELY
BY PART NUMBER. SEE PAGE 63.*

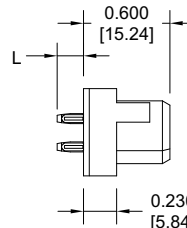

FEMALE

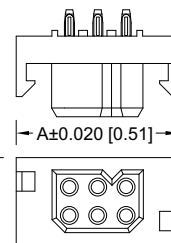

Typical part number:
PLB06F93ST30A1
PLBH06F93ST30A1

| CONTACT CODE | L | PCB THICKNESS | SCREW CODE * |
|--------------|-----------------|-----------------|--------------------------|
| 92 | 0.183 [4.65] | 0.093 [2.36] | ST2 SS2 ST3 SS3 |
| 93 | 0.218 [5.54] | 0.125 [3.18] | ST4 SS4 |

NEW!

PLC COMPLIANT PRESS-FIT CONNECTORS

CODE 92 OR CODE 93

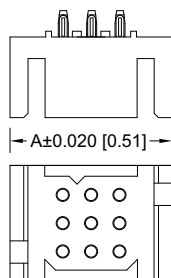

MALE

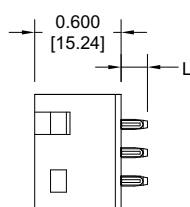

Typical part number:
PLC09M93ST30A1
PLCH09M93ST30A1

**Asterisks determine
gender of connector,
M for male,
F for female and
contact code 92 or 93.

| PART NUMBER | A |
|-----------------------------|------------------|
| PLC09**00A1 PLCH09**00A1 | 1.126 [28.60] |
| PLC12**00A1 PLCH12**00A1 | 1.324 [33.63] |
| PLC18**00A1 PLCH18**00A1 | 1.718 [43.64] |
| PLC24**00A1 PLCH24**00A1 | 2.112 [53.64] |
| PLC30**00A1 PLCH30**00A1 | 2.506 [63.65] |

See page 60
for Installation Tooling.

Plating- See ordering information for
contact plating options.

For connection systems 1,4 and 6.

** MOUNTING SCREWS CAN BE SUP-
PLIED WITH CONNECTORS USING
STEP 5 IN ORDERING INFORMATION
ON PAGE 26. MOUNTING SCREWS
CAN ALSO BE ORDERED SEPARATELY
BY PART NUMBER. SEE PAGE 63.*

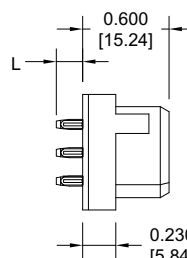

FEMALE

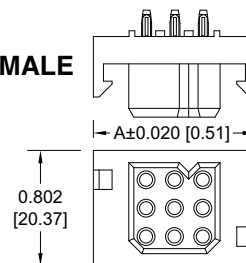

Typical part number:
PLC09F93ST30A1
PLCH09F93ST30A1

| CONTACT CODE | L | PCB THICKNESS | SCREW CODE * |
|--------------|-----------------|-----------------|--------------------------|
| 92 | 0.183 [4.65] | 0.093 [2.36] | ST2 SS2 ST3 SS3 |
| 93 | 0.218 [5.54] | 0.125 [3.18] | ST4 SS4 |

NEW!

DIMENSIONS ARE IN INCHES [MILLIMETERS].
ALL DIMENSIONS ARE SUBJECT TO CHANGE.



Positronic Industries
connectpositronic.com

STRAIGHT SOLDER AND COMPLIANT CONTACT HOLE PATTERN

Power
Connection
Systems

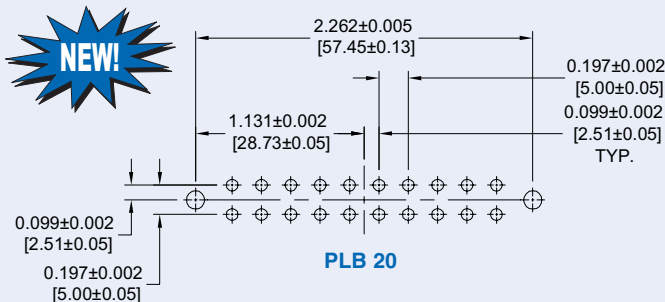
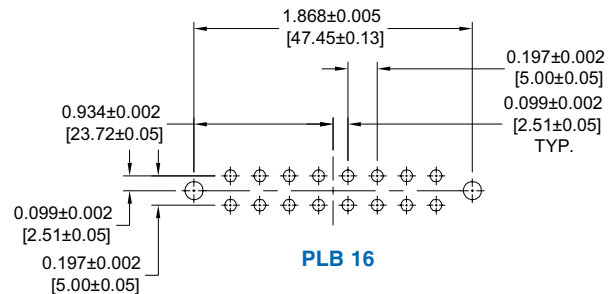
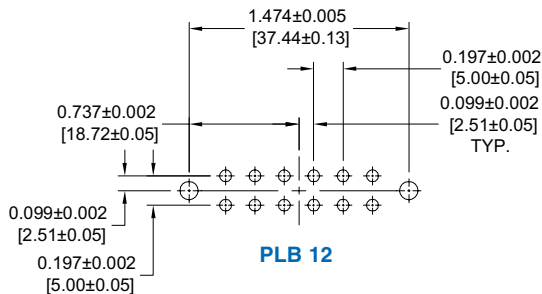
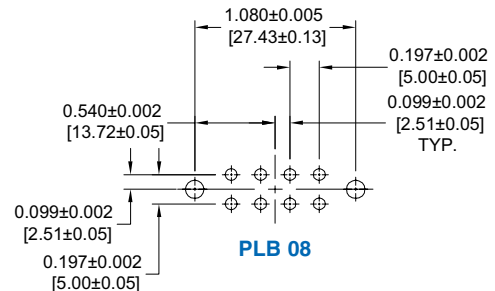
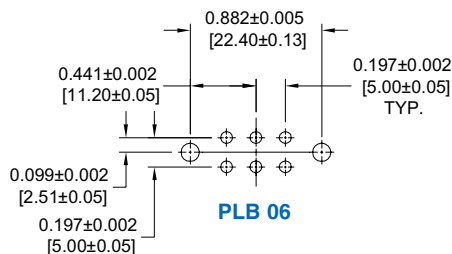
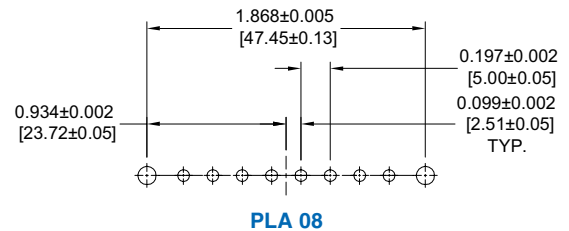
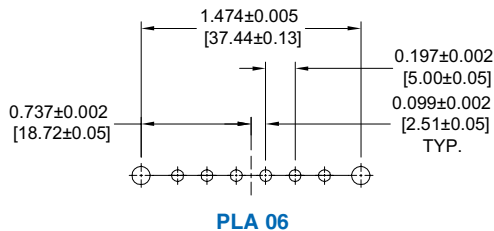
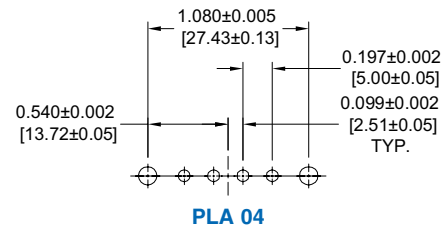
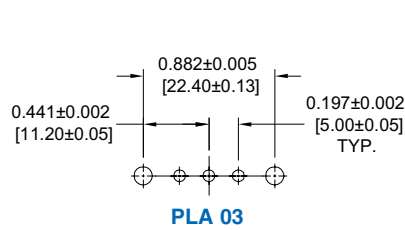

SUGGESTED PRINTED BOARD HOLE SIZES:

Suggest 0.080 [2.03] Ø holes in printed board for solder contact termination positions.

Suggest 0.100 [2.54] Ø holes in printed board when mounting connectors with # 2 thread forming screws.

Suggest 0.123±0.003 [3.15±0.08] Ø holes in printed board when mounting connector with push-on fasteners.

NOTE: See page 61 for suggested printed board drill hole sizes, recommended plating and finished hole sizes for compliant contact termination positions.

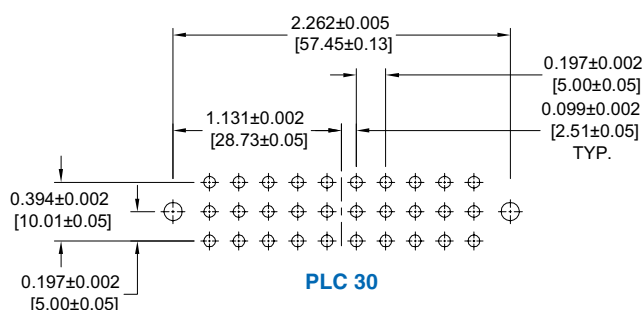
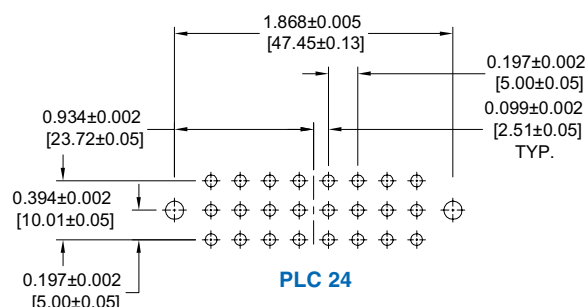
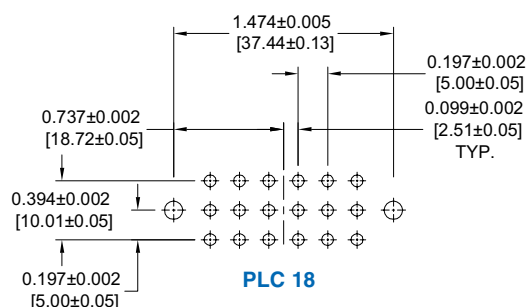
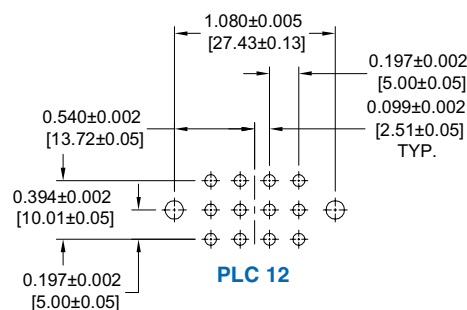
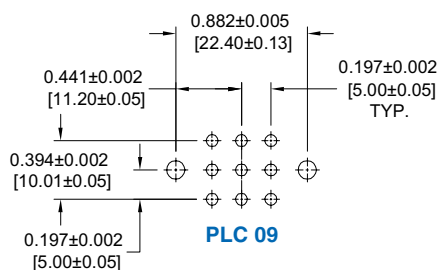

SUGGESTED PRINTED BOARD HOLE SIZES:

Suggest 0.080 [2.03] Ø holes in printed board for solder contact termination positions.

Suggest 0.100 [2.54] Ø holes in printed board when mounting connectors with # 2 thread forming screws.

Suggest 0.123 ± 0.003 [3.15 ± 0.08] Ø holes in printed board when mounting connector with push-on fasteners.

NOTE: See page 61 for suggested printed board drill hole sizes, recommended plating and finished hole sizes for compliant contact termination positions.

Connectors Designed To Customer Specifications

Positronic connectors can be modified to customers specifications.

Examples: select loading of contacts for cost savings or to gain creepage and clearance distances; longer PCB terminations; customer specified hardware.

Positronic can develop and tool new connector designs with reasonable price and delivery.

Contact Technical Sales with your particular requirements.



Positronic Industries
connectpositronic.com

RIGHT ANGLE (90°) SOLDER PRINTED BOARD CONNECTOR

Power
Connection
Systems

PLA RIGHT ANGLE (90°) PRINTED BOARD MOUNT CODE 4, 0.146 [3.71] CONTACT EXTENSION

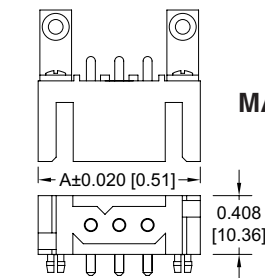

MALE

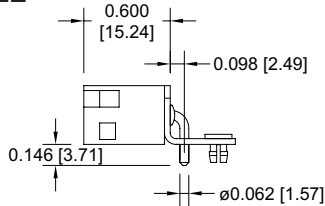

Typical part number:
PLA03M4BN0A1
PLAH03M4BN0A1

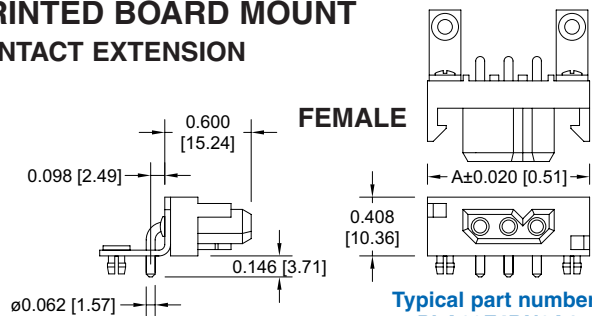

FEMALE

Typical part number:
PLA03F4BN0A1
PLAH03F4BN0A1

*Asterisk determines
gender of connector,
M for male,
F for female.

| PART NUMBER | A | PART NUMBER | A |
|--------------|---------------|--------------|---------------|
| PLA03*400A1 | 1.126 [28.60] | PLA06*400A1 | 1.718 [43.64] |
| PLAH03*400A1 | 1.324 [33.63] | PLAH06*400A1 | 2.112 [53.64] |
| PLA04*400A1 | 1.324 [33.63] | PLA08*400A1 | 2.112 [53.64] |
| PLAH04*400A1 | 1.718 [43.64] | PLAH08*400A1 | 2.112 [53.64] |

Plating- See ordering information for
contact plating options.

For connection systems 1, 2 and 5.

PLB RIGHT ANGLE (90°) PRINTED BOARD MOUNT CODE 4, 0.146 [3.71] CONTACT EXTENSION

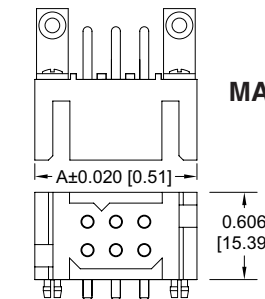

MALE

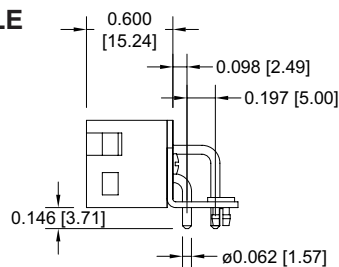

Typical part number:
PLB06M4BN0A1
PLBH06M4BN0A1

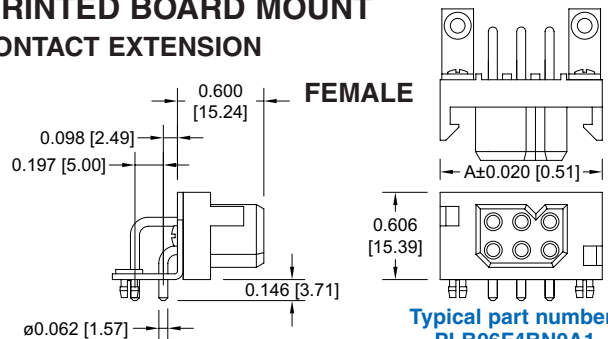

FEMALE

Typical part number:
PLB06F4BN0A1
PLBH06F4BN0A1

*Asterisk determines
gender of connector,
M for male,
F for female.

| PART NUMBER | A | PART NUMBER | A |
|--------------|---------------|--------------|---------------|
| PLB06*400A1 | 1.126 [28.60] | PLB16*400A1 | 2.112 [53.64] |
| PLBH06*400A1 | 1.324 [33.63] | PLBH16*400A1 | 2.506 [63.65] |
| PLB08*400A1 | 1.324 [33.63] | PLB20*400A1 | 2.506 [63.65] |
| PLBH08*400A1 | 1.718 [43.64] | PLBH20*400A1 | 2.506 [63.65] |
| PLB12*400A1 | 1.718 [43.64] | | |
| PLBH12*400A1 | 1.718 [43.64] | | |

Plating- See ordering information for
contact plating options.

For connection systems 1, 2 and 5.

PLC RIGHT ANGLE (90°) PRINTED BOARD MOUNT CODE 4, 0.146 [3.71] CONTACT EXTENSION

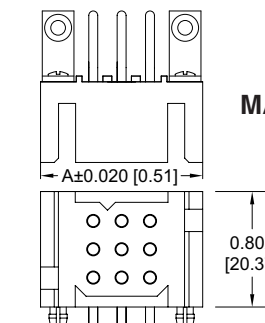

MALE

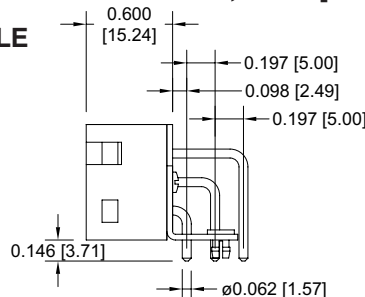

Typical part number:
PLC09M4BN0A1
PLCH09M4BN0A1

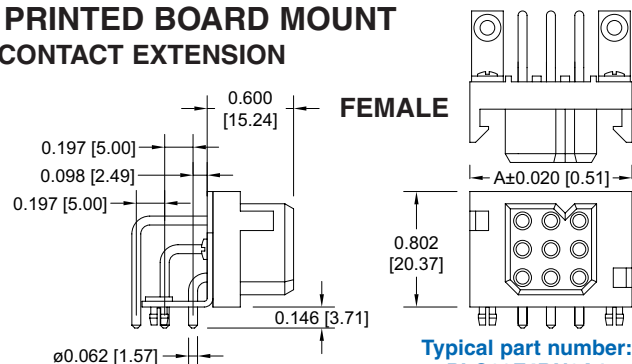

FEMALE

Typical part number:
PLC09F4BN0A1
PLCH09F4BN0A1

*Asterisk determines
gender of connector,
M for male,
F for female.

| PART NUMBER | A | PART NUMBER | A |
|--------------|---------------|--------------|---------------|
| PLC09*400A1 | 1.126 [28.60] | PLC24*400A1 | 2.112 [53.64] |
| PLCH09*400A1 | 1.324 [33.63] | PLCH24*400A1 | 2.506 [63.65] |
| PLC12*400A1 | 1.324 [33.63] | PLC30*400A1 | 2.506 [63.65] |
| PLCH12*400A1 | 1.718 [43.64] | PLCH30*400A1 | 2.506 [63.65] |
| PLC18*400A1 | 1.718 [43.64] | | |
| PLCH18*400A1 | 1.718 [43.64] | | |

Plating- See ordering information for
contact plating options.

For connection systems 1, 2 and 5.

PLA RIGHT ANGLE (90°) PRINTED BOARD MOUNT CODE 42, 0.377 [9.58] CONTACT EXTENSION

MALE

FEMALE

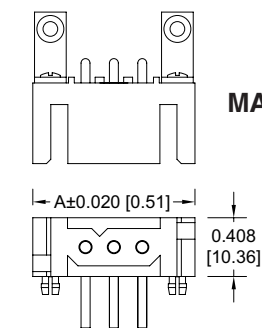

Typical part number:
PLA03M42BN0A1
PLAH03M42BN0A1

*Asterisk determines
gender of connector,
M for male,
F for female.

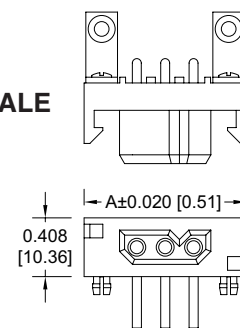
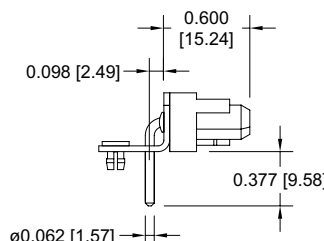
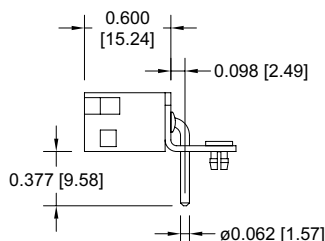

Typical part number:
PLA03F42BN0A1
PLAH03F42BN0A1

| PART NUMBER | A | PART NUMBER | A |
|---------------|---------------|---------------|---------------|
| PLA03*4200A1 | 1.126 [28.60] | PLA06*4200A1 | 1.718 [43.64] |
| PLAH03*4200A1 | 1.324 [33.63] | PLAH06*4200A1 | 2.112 [53.64] |
| PLA04*4200A1 | 1.324 [33.63] | PLA08*4200A1 | 2.112 [53.64] |
| PLAH04*4200A1 | 1.718 [43.64] | PLAH08*4200A1 | 2.112 [53.64] |

Plating- See ordering information for
contact plating options.

For connection systems 1,2,3 and 5.

PLB RIGHT ANGLE (90°) PRINTED BOARD MOUNT CODE 42, 0.377 [9.58] CONTACT EXTENSION

MALE

FEMALE

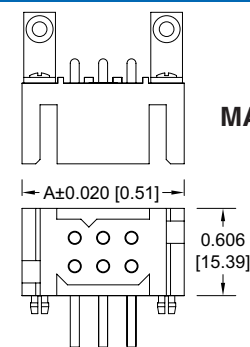

Typical part number:
PLB06M42BN0A1
PLBH06M42BN0A1

*Asterisk determines
gender of connector,
M for male,
F for female.

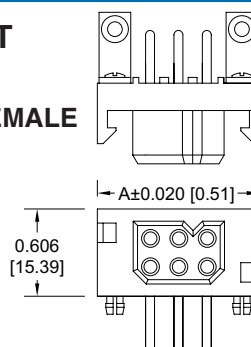
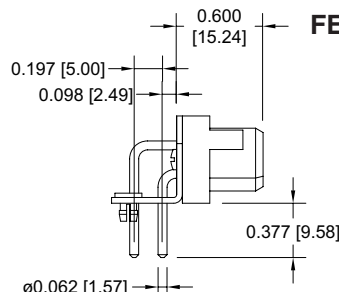
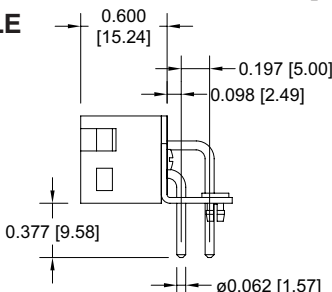

Typical part number:
PLB06F42BN0A1
PLBH06F42BN0A1

| PART NUMBER | A | PART NUMBER | A |
|---------------|---------------|---------------|---------------|
| PLB06*4200A1 | 1.126 [28.60] | PLB16*4200A1 | 2.112 [53.64] |
| PLBH06*4200A1 | 1.718 [43.64] | PLBH16*4200A1 | 2.506 [63.65] |
| PLB08*4200A1 | 1.324 [33.63] | PLB20*4200A1 | 2.506 [63.65] |
| PLBH08*4200A1 | 1.718 [43.64] | PLBH20*4200A1 | 2.506 [63.65] |
| PLB12*4200A1 | 1.718 [43.64] | | |
| PLBH12*4200A1 | 1.718 [43.64] | | |

Plating- See ordering information for
contact plating options.

For connection systems 1,2,3 and 5.

PLC RIGHT ANGLE (90°) PRINTED BOARD MOUNT CODE 42, 0.377 [9.58] CONTACT EXTENSION

MALE

FEMALE

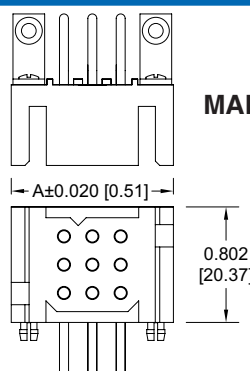

Typical part number:
PLC09M42BN0A1
PLCH09M42BN0A1

*Asterisk determines
gender of connector,
M for male,
F for female.

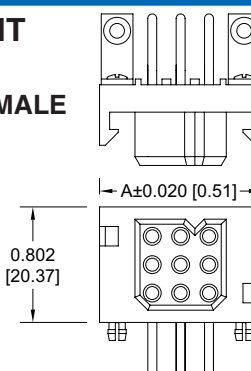
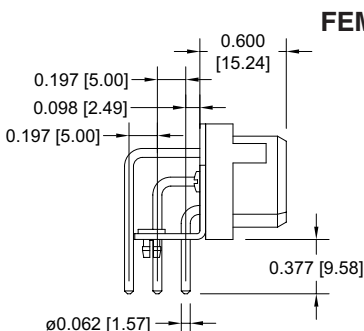
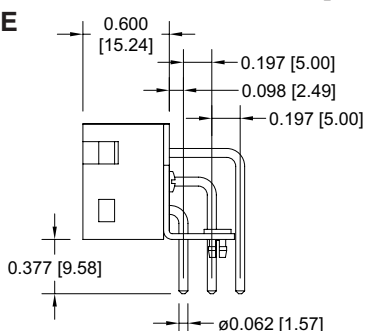

Typical part number:
PLC09F42BN0A1
PLCH09F42BN0A1

| PART NUMBER | A | PART NUMBER | A |
|---------------|---------------|---------------|---------------|
| PLC09*4200A1 | 1.126 [28.60] | PLC24*4200A1 | 2.112 [53.64] |
| PLCH09*4200A1 | 1.324 [33.63] | PLCH24*4200A1 | 2.506 [63.65] |
| PLC12*4200A1 | 1.324 [33.63] | PLC30*4200A1 | 2.506 [63.65] |
| PLCH12*4200A1 | 1.718 [43.64] | PLCH30*4200A1 | 2.506 [63.65] |
| PLC18*4200A1 | 1.718 [43.64] | | |
| PLCH18*4200A1 | 1.718 [43.64] | | |

Plating- See ordering information for
contact plating options.

For connection systems 1,2,3 and 5.



Positronic Industries
connectpositronic.com

RIGHT ANGLE (90°) PRESS-FIT CONNECTOR FOR USE WITH "FLAT ROCK" TOOLING

Power
Connection
Systems

PLA RIGHT ANGLE (90°) PRESS-FIT CONNECTOR

CODE 62 OR CODE 63

For connection systems 1,2 and 5.

MALE

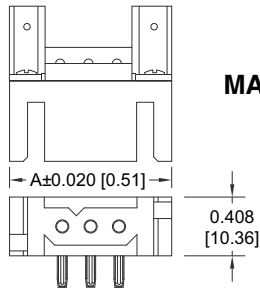

Typical part number:
PLA03M63B30A1
PLAH03M63B30A1

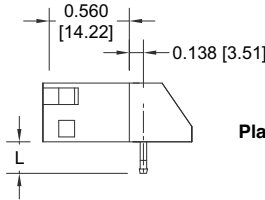

Plating- See ordering
information for
contact plating
options.

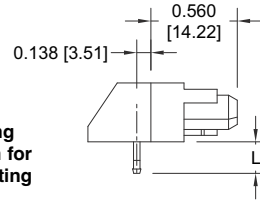

FEMALE

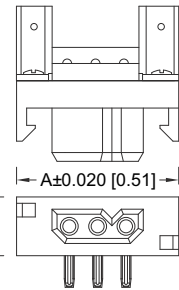

Typical part number:
PLA03F63B30A1
PLAH03F63B30A1

| PART NUMBER | A | PART NUMBER | A |
|--------------|------------------|--------------|------------------|
| PLA03**B30A1 | 1.126 [28.60] | PLA06**B30A1 | 1.718 [43.64] |
| PLA04**B30A1 | 1.324 [33.63] | PLA08**B30A1 | 2.112 [53.64] |

**Asterisk determines gender of connector, M for male, F for female, and contact code 62 or 63.

CONNECTORS ARE
DESIGNED TO BE
MOUNTED TO THE PCB
WITH SCREWS, SEE
SCREW CODE.

| CONTACT CODE | L | PCB THICKNESS | SCREW P/N * |
|--------------|-----------------|-----------------|--|
| 62 | 0.183 [4.65] | 0.093 [2.36] | Mounting screws are ordered separately. See page 63. |
| 63 | 0.219 [5.56] | 0.125 [3.18] | |

PLB RIGHT ANGLE (90°) PRESS-FIT CONNECTOR

CODE 62 OR CODE 63

For connection systems 1,2 and 5.

MALE

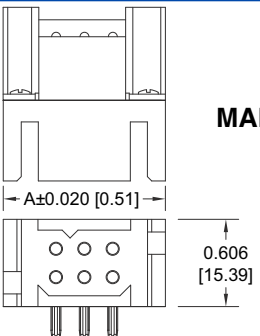

Typical part number:
PLB06M63B30A1
PLBH06M63B30A1

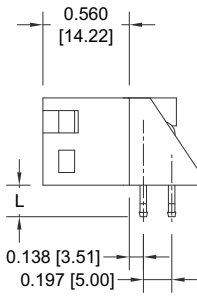

Plating- See ordering
information for
contact plating
options.

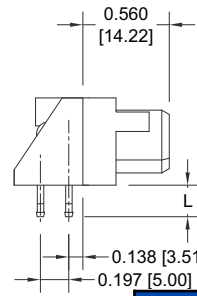

FEMALE

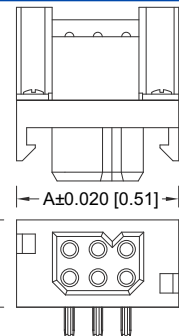

Typical part number:
PLB06F63B30A1
PLBH06F63B30A1

| PART NUMBER | A | PART NUMBER | A |
|--------------|------------------|--------------|------------------|
| PLB06**B30A1 | 1.126 [28.60] | PLB12**B30A1 | 1.718 [43.64] |
| PLB08**B30A1 | 1.324 [33.63] | PLB16**B30A1 | 2.112 [53.64] |

**Asterisk determines gender of connector, M for male, F for female, and contact code 62 or 63.

CONNECTORS ARE
DESIGNED TO BE
MOUNTED TO THE PCB
WITH SCREWS, SEE
SCREW CODE.

| CONTACT CODE | L | PCB THICKNESS | SCREW P/N * |
|--------------|-----------------|-----------------|--|
| 62 | 0.183 [4.65] | 0.093 [2.36] | Mounting screws are ordered separately. See page 63. |
| 63 | 0.219 [5.56] | 0.125 [3.18] | |

PLC RIGHT ANGLE (90°) PRESS-FIT CONNECTOR

CODE 62 OR CODE 63

For connection systems 1,2 and 5.

MALE

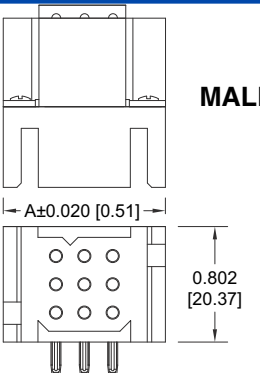

Typical part number:
PLC09M63B30A1
PLCH09M63B30A1

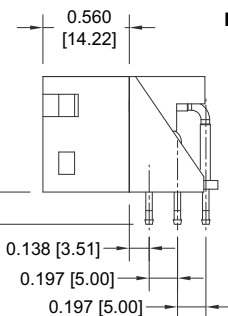

Plating- See ordering
information for
contact plating
options.

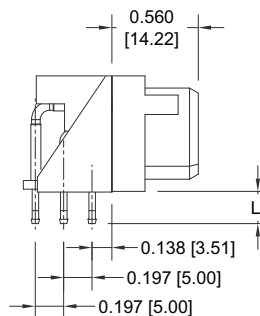

FEMALE

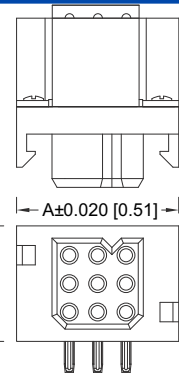

Typical part number:
PLC09F63B30A1
PLCH09F63B30A1

| PART NUMBER | A | PART NUMBER | A |
|--------------|------------------|--------------|------------------|
| PLC09**B30A1 | 1.126 [28.60] | PLC24**B30A1 | 2.112 [53.64] |
| PLC12**B30A1 | 1.324 [33.63] | PLC30**B30A1 | 2.506 [63.65] |
| PLC18**B30A1 | 1.718 [43.64] | | |

**Asterisk determines gender of connector, M for male, F for female, and contact code 62 or 63.

CONNECTORS ARE
DESIGNED TO BE
MOUNTED TO THE PCB
WITH SCREWS, SEE
SCREW CODE.

| CONTACT CODE | L | PCB THICKNESS | SCREW P/N * |
|--------------|-----------------|-----------------|--|
| 62 | 0.183 [4.65] | 0.093 [2.36] | Mounting screws are ordered separately. See page 63. |
| 63 | 0.219 [5.56] | 0.125 [3.18] | |

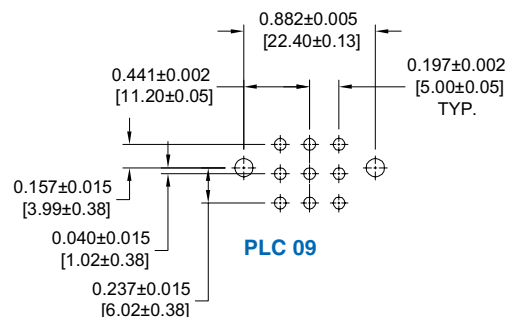
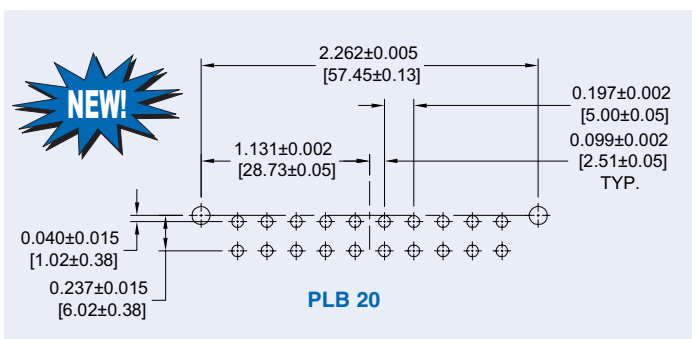
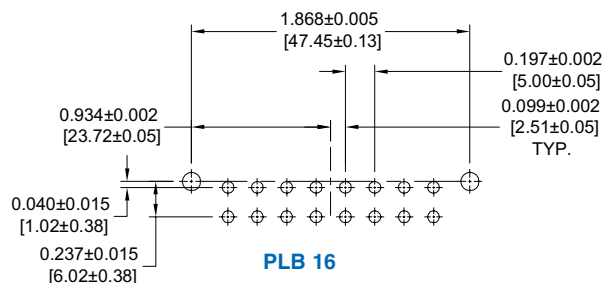
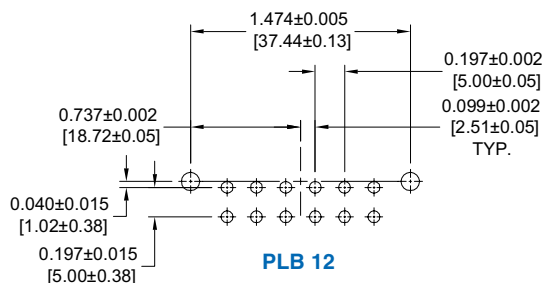
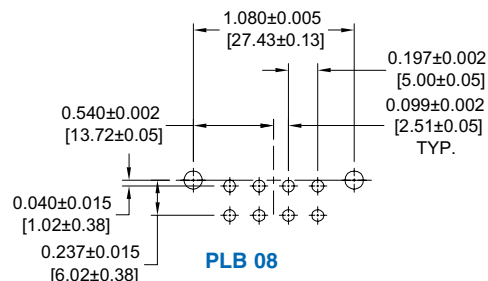
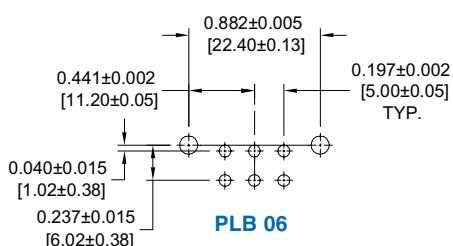
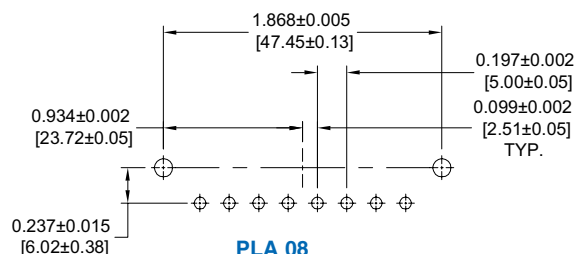
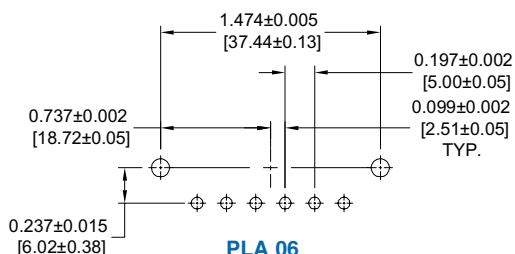
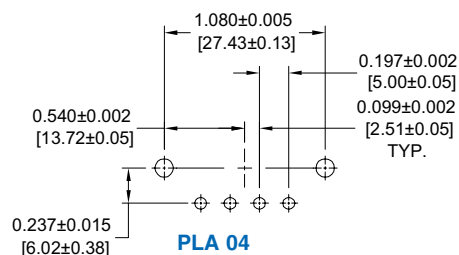
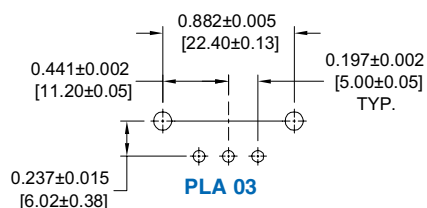

See page 20 for suggested printed board hole sizes.

DIMENSIONS ARE IN INCHES [MILLIMETERS].
ALL DIMENSIONS ARE SUBJECT TO CHANGE.



Positronic Industries
connectpositronic.com

RIGHT ANGLE (90°) PRINTED BOARD CONTACT HOLE PATTERN AND PANEL MOUNT CONNECTOR WITH SOLDER CUP CONTACTS

Power
Connection
Systems

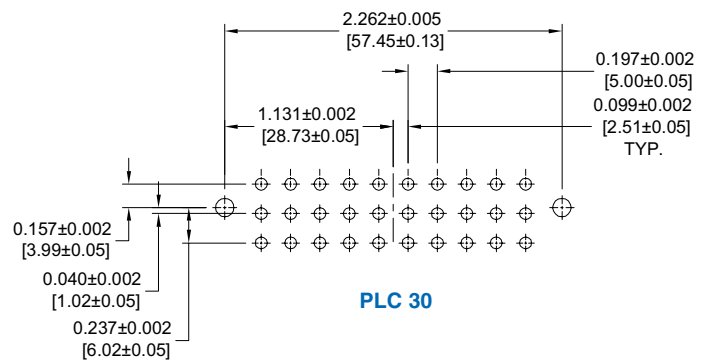
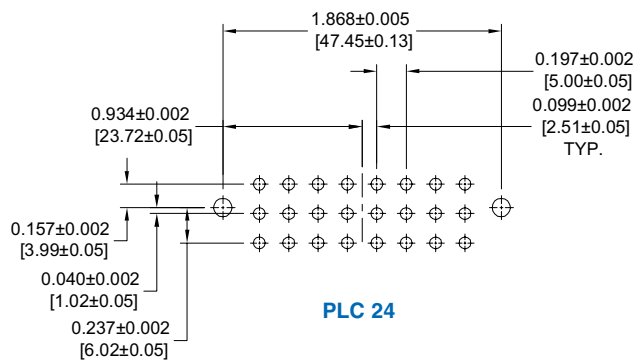
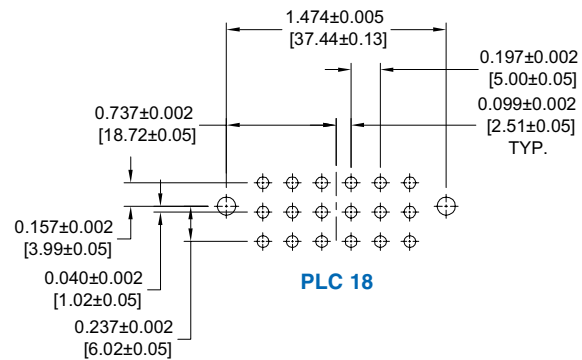
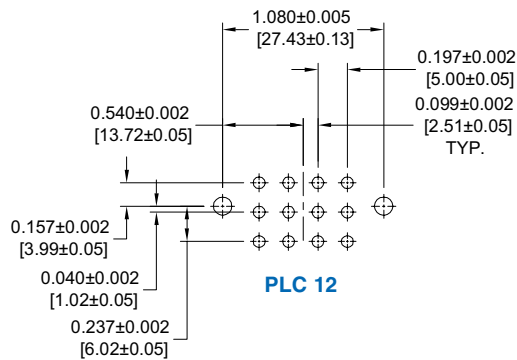

SUGGESTED PRINTED BOARD HOLE SIZES:

Suggest 0.080 [2.03] Ø holes in printed board for solder contact termination positions.

Suggest 0.123±0.003 [3.15±0.08] Ø holes in printed board when mounting connector with push-on fasteners.

NOTE: See page 61 for suggested printed board drill hole sizes, recommended plating and finished hole sizes for compliant contact termination positions.



PANEL MOUNT CONNECTORS WITH SOLDER CUP CONTACTS

CODE 2, 18 AWG [1.00mm²] MAX.

MALE

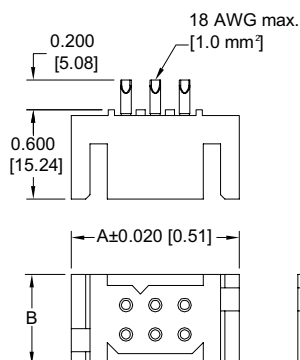

TYPICAL PART NUMBER:
PLB06M200A1

FEMALE

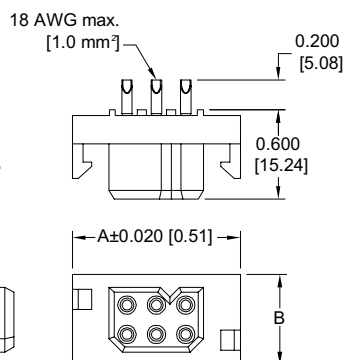

TYPICAL PART NUMBER:
PLB06F200A1

For connection system 8.

| CONNECTOR VARIANTS | A | B |
|--------------------|---------------|---------------|
| PLA03 | 1.126 [28.60] | 0.408 [10.36] |
| PLA04 | 1.324 [33.63] | 0.408 [10.36] |
| PLA06 | 1.718 [43.64] | 0.408 [10.36] |
| PLA08 | 2.112 [53.64] | 0.408 [10.36] |
| PLB06 | 1.126 [28.60] | 0.606 [15.39] |
| PLB08 | 1.324 [33.63] | 0.606 [15.39] |
| PLB12 | 1.718 [43.64] | 0.606 [15.39] |
| PLB16 | 2.112 [53.64] | 0.606 [15.39] |
| NEW! PLB20 | 2.506 [63.65] | 0.606 [15.39] |
| PLC09 | 1.126 [28.60] | 0.802 [30.37] |
| PLC12 | 1.324 [33.63] | 0.802 [30.37] |
| PLC18 | 1.718 [43.64] | 0.802 [30.37] |
| PLC24 | 2.112 [53.64] | 0.802 [30.37] |
| PLC30 | 2.506 [63.65] | 0.802 [30.37] |

MALE INSULATOR DIMENSIONS FOR CABLE CONNECTORS WITH SIZE 16 REMOVABLE CONTACTS CODE 0 OR CODE 7 CONTACTS ARE NOT SUPPLIED WITH CONNECTOR AND MUST BE ORDERED SEPARATELY

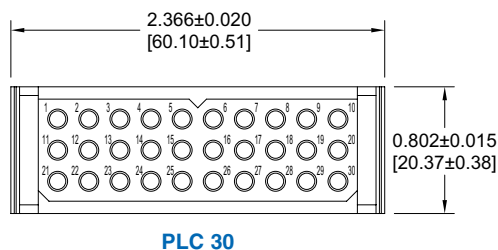
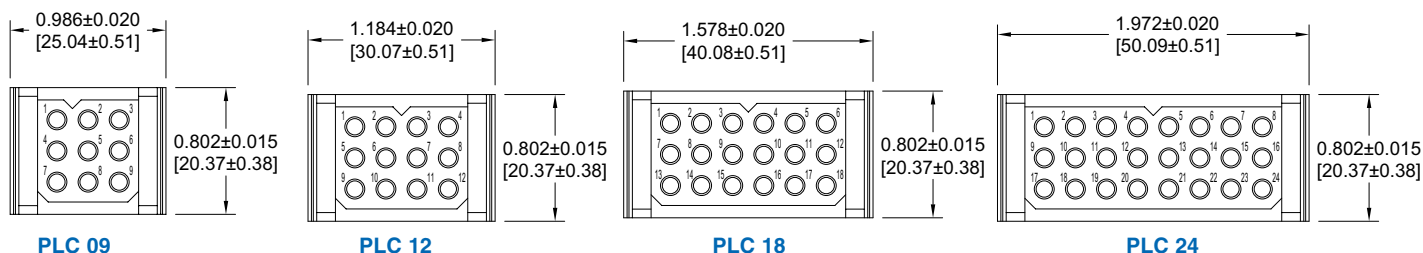
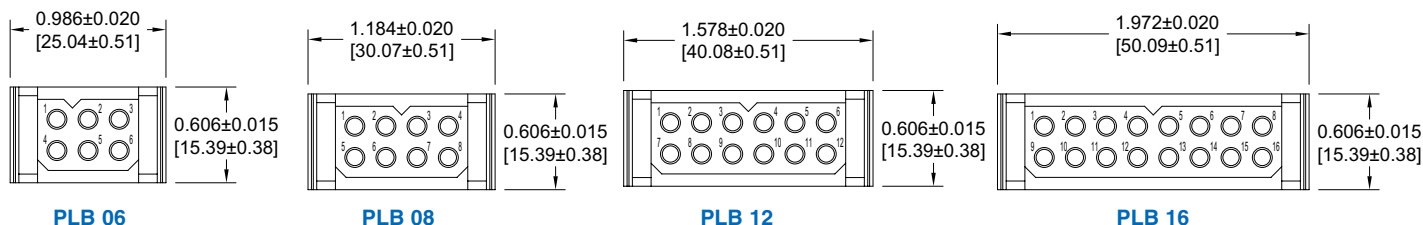
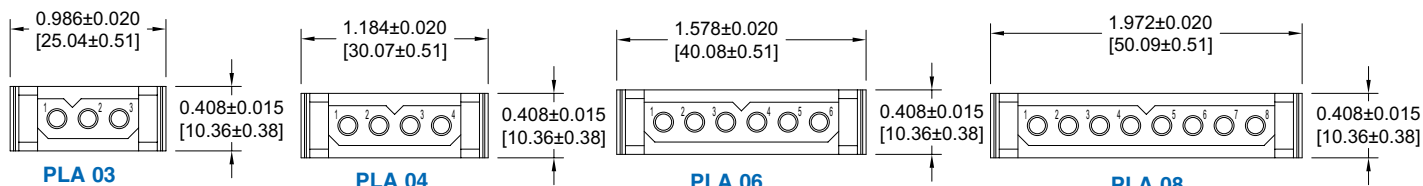
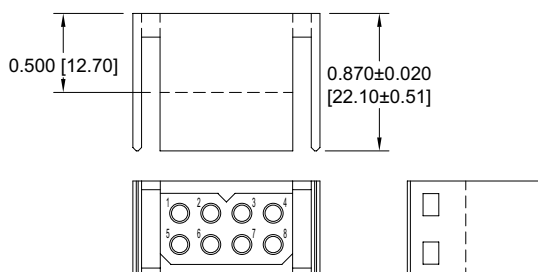

*For information regarding
size 16 removable contacts,
see Removable Contact section,
pages 47-53.*



Positronic Industries
connectpositronic.com

FEMALE INSULATOR DIMENSIONS FOR CABLE CONNECTORS

Power
Connection
Systems

FEMALE INSULATOR DIMENSIONS FOR CABLE CONNECTORS WITH SIZE 16 REMOVABLE CONTACTS

CODE 0 OR CODE 7

CONTACTS ARE NOT SUPPLIED WITH CONNECTOR AND MUST BE ORDERED SEPARATELY

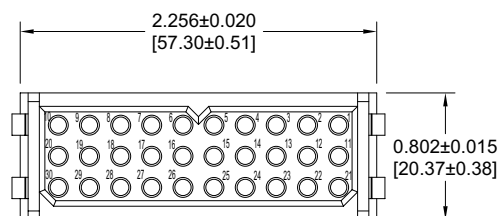
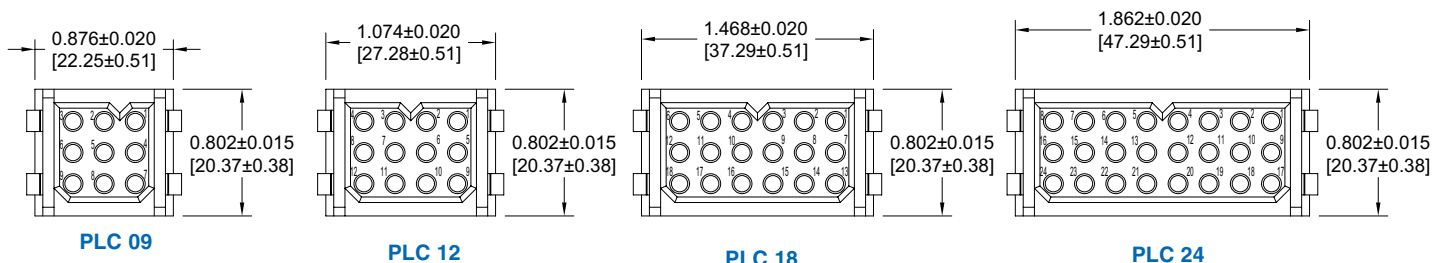
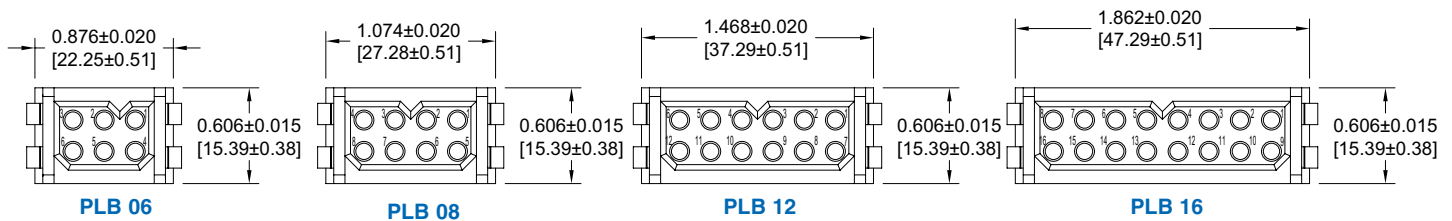
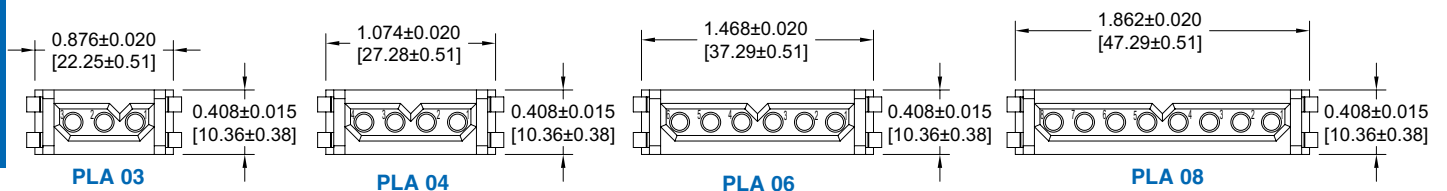
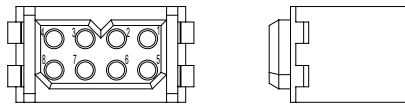
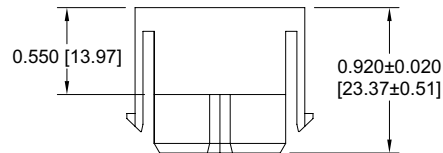

*For information regarding
size 16 removable contacts,
see Removable Contact section,
pages 47-53.*

MALE INSULATOR DIMENSIONS FOR PANEL MOUNT CONNECTORS WITH SIZE 16 REMOVABLE CONTACTS

CODE 1 OR CODE 8

CONTACTS ARE NOT SUPPLIED WITH CONNECTOR AND MUST BE ORDERED SEPARATELY

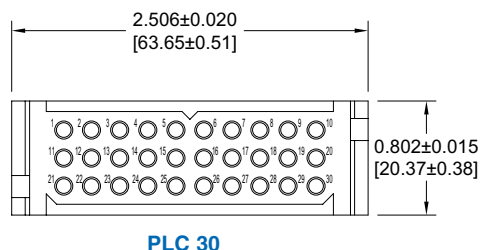
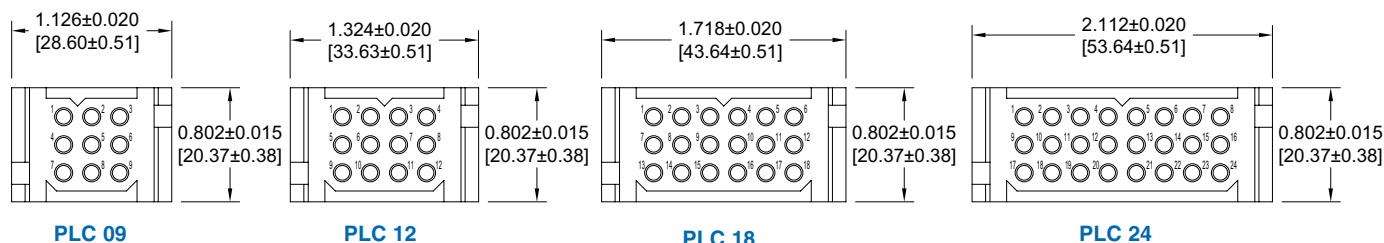
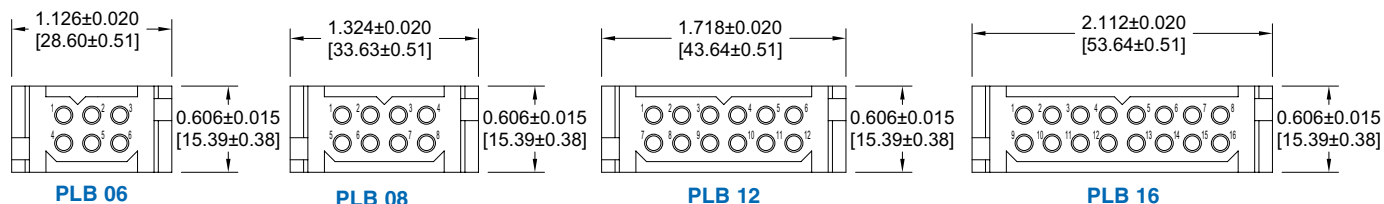
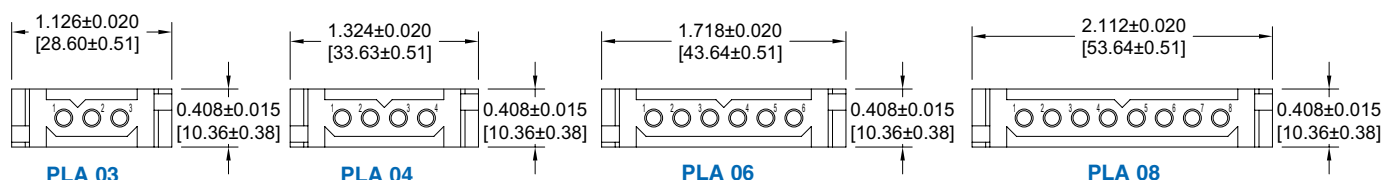
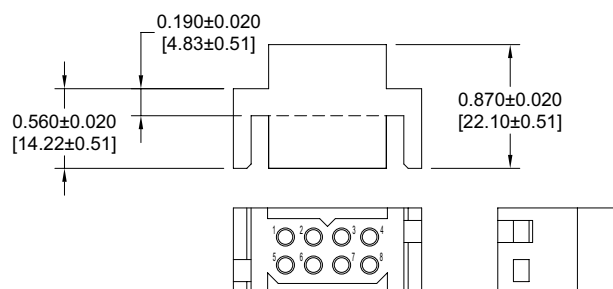

For information
regarding panel
cutouts, see
page 67.

*For information regarding
size 16 removable contacts,
see Removable Contact section,
pages 47-53.*



Positronic Industries
connectpositronic.com

FEMALE INSULATOR DIMENSIONS FOR PANEL MOUNT CONNECTORS

Power
Connection
Systems

FEMALE INSULATOR DIMENSIONS FOR PANEL MOUNT CONNECTORS WITH SIZE 16 REMOVABLE CONTACTS

CODE 1 OR CODE 8

CONTACTS ARE NOT SUPPLIED WITH CONNECTOR AND MUST BE ORDERED SEPARATELY

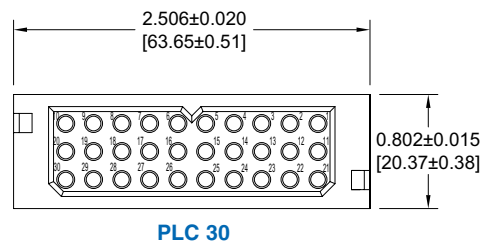
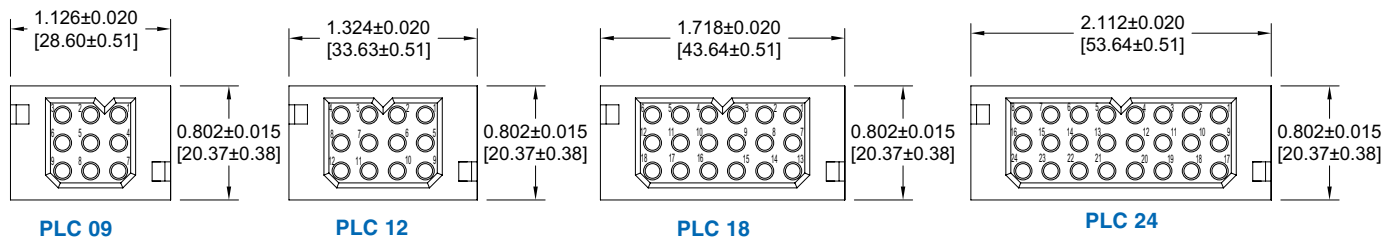
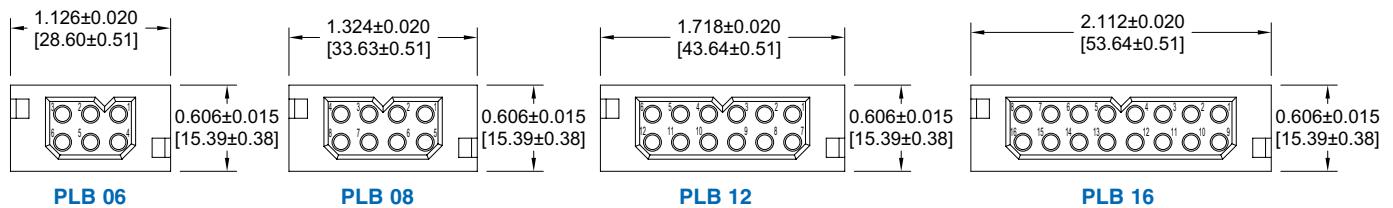
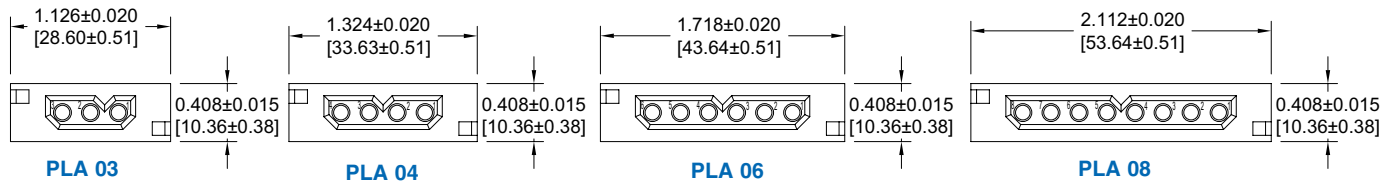
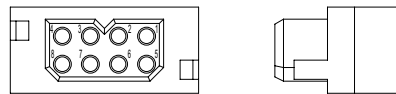
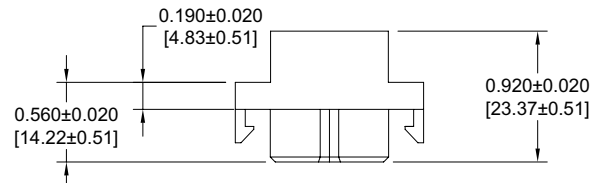

For information
regarding panel
cutouts, see
page 67.

For information regarding
size 16 removable contacts,
see Removable Contact section,
pages 47-53.

SEQUENTIAL MATING SYSTEM

*REMOVABLE CONTACTS FOR CABLE CONNECTORS MUST BE ORDERED SEPARATELY
FOR CONTACT SELECTION, SEE SIZE 16 CONTACTS ON PAGE 49

EXAMPLE 1

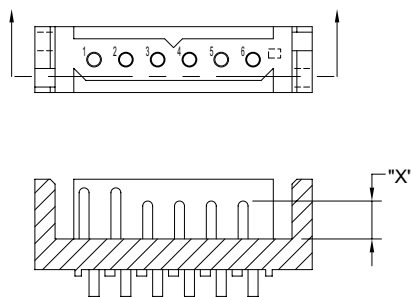

Typical Part Number:
PLA06M300A1-E1B2B

| LENGTH CODE | "X" CONTACT LENGTH |
|-------------|--------------------|
| A | 0.370 [9.40] |
| B | 0.330 [8.38] |
| C | 0.310 [7.87] |
| D | 0.290 [7.37] |
| E | 0.250 [6.35] |

| MATING CONNECTOR TYPE | CONTACT OPTIONS |
|-----------------------|-----------------|
| Board to Board | B, D, E |
| Board to Cable* | A, C, E |
| Cable to Cable* | A, D |

EXAMPLE 2

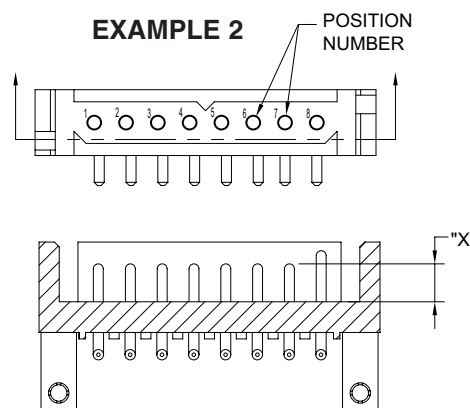

Typical Part Number:
PLA08M4B0C1-D8B

SEQUENTIAL MATING SYSTEM

CRIMP REMOVABLE CONTACT PART NUMBERS

| WIRE SIZE AWG/[mm ²] | LENGTH CODE "A" | LENGTH CODE "C" | LENGTH CODE "D" | LENGTH CODE "E" |
|-------------------------------------|-----------------|-----------------|-----------------|-----------------|
| 12 - 14 [4.0 - 2.5] | MC112N-133.3 | MC112N-133.2 | MC112N-133.1 | MC112N-133.0 |
| 16 - 18 - 20 [1.5 - 1.0 - 0.5] | MC116N-133.3 | MC116N-133.2 | MC116N-133.1 | MC116N-133.0 |

*For information regarding
size 16 removable contacts,
see Removable Contact section,
pages 47-53.*

SELECTION GUIDE FOR ORDERING DIFFERENT CONTACT LENGTHS

STEP 9 OF ORDERING INFORMATION

SELECT CONNECTOR USING ORDERING INFORMATION ON PAGE 26
THEN CHOOSE STEPS BELOW FOR SEQUENTIAL MATING SYSTEM CONTACTS

| STEP | 1 | 2 | 3 | 4 | 5 | 6 | 7 | 8 | 9 |
|---------|---|---|---|---|---|---|---|---|---|
| EXAMPLE | E | 1 | B | 2 | B | 3 | D | 4 | D |

STEP 1

Specify code for most frequently used contact mating length. This length is used for all contacts not specified in steps 2 through 9.

STEP 2

Position number for first special length contact.

STEP 3

Length of contact specified in step 2. (Choose from length code chart)

STEP 4

Position number for second special length contact.

STEP 9

Length of contact specified in step 8 (Choose from length code chart).

STEP 8

Position number for fourth special length contact.

STEP 7

Length of contact specified in step 6 (Choose from length code chart).

STEP 6

Position number for third special length contact.

STEP 5

Length of contact specified in step 4 (Choose from length code chart).



Positronic Industries
connectpositronic.com

PCS SERIES CONNECTOR ORDERING INFORMATION

Power
Connection
Systems

ORDERING INFORMATION - CODE NUMBERING SYSTEM

Specify Complete Connector By Selecting An Option From Step 1 Through 7

| STEP | 1 | 2 | 3 | 4 | 5 | 6 | 7 | 8 | 9 |
|---------|-----|----|---|---|---|---|----|-----|---|
| EXAMPLE | PLB | 06 | F | 3 | 0 | 0 | A1 | /AA | — |

STEP 1 - BASIC SERIES

PLA - 1 Row
PLAH - 1 Row High conductivity contacts
PLB - 2 Row
PLBH - 2 Row High conductivity contacts
PLC - 3 Row
PLCH - 3 Row High conductivity contacts

STEP 2 - CONNECTOR VARIANTS

1 Row - 03, 04, 06, 08
2 Row - 06, 08, 12, 16, **20
3 Row - 09, 12, 18, 24, 30

STEP 3 - CONNECTOR GENDER

M - Male
F - Female

STEP 4 - CONTACT TERMINATION TYPE

- * 0 - Order contacts separately for cable connectors for connection systems 5, 6, 7, 8 and 9, see pages 47-53.
- * 1 - Removable contact, panel mounted connector for connection system 8. Order contacts separately, see pages 47-53.
- 2 - Solder Cup, 18 AWG [1.0mm²] max. for panel mount connector, for connection system 8. Not available as PL*H.
- 3 - Solder, Straight Printed Board Mount with 0.146 [3.71] tail extension for connection systems 1, 4 and 6.
- 32 - Solder, Straight Printed Board Mount with 0.377 [9.58] tail extension for connection system 3 and systems 1, 4 and 6.
- 4 - Solder, Right Angle (90°) Printed Board Mount with 0.146 [3.71] tail extension for connection systems 1, 2 and 5.
- 42 - Solder, Right Angle (90°) Printed Board Mount with 0.377 [9.58] tail extension for connection system 3 and systems 1, 2 and 5.
- ***62 - Press-fit, compliant Termination Right Angle (90°) Printed Board Mount, termination length 0.183 [4.65]. Must select "B3" in step 5.
- ***63 - Press-fit, compliant Termination Right Angle (90°) Printed Board Mount, termination length 0.219 [5.56]. Must select "B3" in step 5.
- * 7 - Order contacts separately for cable connectors for connection systems 5, 6, 7, 8 and 9, see pages 47-53. Terminating side of insulator has 0.165 [4.19] \varnothing c'bore for large wire sizes.
- * 8 - Removable contact, panel mounted connector for connection system 8. Order contacts separately, see pages 47-53. Terminating side of insulator has 0.165 [4.19] \varnothing c'bore for large wire sizes.
- 92 - Straight PCB Mount, Press-Fit, length 0.183 [4.65] for 0.093 inch [2.36] thick board.
- 93 - Straight PCB Mount, Press-Fit, length 0.218 [5.54] for 0.125 inch [3.18] thick board.

STEP 5 - MOUNTING STYLE

- 0 - None.
- B - Metal Right Angle (90°) Mounting Bracket.
- BN - Metal Right Angle (90°) Mounting Bracket with Push-on Fastener.
- B3 - Plastic Right Angle (90°) Mounting Bracket with Cross Bar.
- B3N - Plastic Right Angle (90°) Mounting Bracket with Cross Bar and Push-on Fastener.
- N - Push-On Fastener For Straight Printed Board Mount Connectors
- ST2 - Self-tapping steel screws 2-28 x 0.250±0.030 [6.35±0.76] length for 0.093 [2.36] thick board. *Use with contact code 62, 63, 92 or 93.*
- ST3 - Self-tapping steel screws 2-28 x 0.312±0.030 [7.92±0.76] length for 0.125 [3.18] thick board. *Use with contact code 62, 63, 92 or 93.*
- ST4 - Self-tapping steel screws 2-28 x 0.375±0.030 [9.53±0.76] length for 0.175 [4.45] thick board. *Use with contact code 62, 63, 92 or 93.*
- SS2 - Self-tapping stainless steel screws 2-28 x 0.250±0.030 [6.35±0.76] length for 0.093 [2.36] thick board. *Use with contact code 62, 63, 92 or 93.*
- SS3 - Self-tapping stainless steel screws 2-28 x 0.312±0.030 [7.92±0.76] length for 0.125 [3.18] thick board. *Use with contact code 62, 63, 92 or 93.*
- SS4 - Self-tapping stainless steel screws 2-28 x 0.375±0.030 [9.53±0.76] length for 0.175 [4.45] thick board. *Use with contact code 62, 63, 92 or 93.*

STEP 9 - SPECIAL OPTIONS

Sequential Mating Systems refer to page 25.

CONTACT TECHNICAL SALES FOR SPECIAL OPTIONS

STEP 8 - ENVIRONMENTAL COMPLIANCE OPTIONS

/AA - Compliant per EU Directive 2002/95/EC (RoHS)

NOTE: If compliance to environmental legislation is not required, this step will not be used.
Example: PLB06F300A1

STEP 7 - CONTACT PLATING FOR PRINTED BOARD CONNECTORS

- 0 - Crimp Contacts ordered separately, see pages 47-53.
- A1 - Gold flash over nickel on mating end and termination end.
- A2 - Gold flash over nickel on mating end and 0.00020 inch [5.00 μ] tin-lead solder coat on termination end. Not available with code 62, 63, 92 or 93 in step 4.
- C1 - 0.000030 inch [0.76 μ] gold over nickel on mating end and termination end.
- C2 - 0.000030 inch [0.76 μ] gold over nickel on mating end and 0.00020 inch [5.00 μ] tin-lead solder coated termination end. Not available with code 62, 63, 92 or 93 in step 4.
- D1 - 0.000050 inch [1.27 μ] gold over nickel on mating end and termination end.
- D2 - 0.000050 inch [1.27 μ] gold over nickel on mating end and 0.00020 inch [5.00 μ] tin-lead solder coated termination end. Not available with code 62, 63, 92 or 93 in step 4.

STEP 6 - HOODS AND PANEL MOUNT

- 0 - None.
- 5 - Top Opening Hood.
- 6 - Panel Mount, quick release.
- 81 - Panel Mount, fixed for 0.040 [1.02] thick panel.
- 82 - Panel Mount, fixed for 0.060 [1.52] thick panel.
- 83 - Panel Mount, fixed for 0.090 [2.29] thick panel.
- 11 - Blind Mating System for 0.040 [1.02] thick panel.
- 12 - Blind Mating System for 0.060 [1.52] thick panel.
- 13 - Blind Mating System for 0.090 [2.29] thick panel.
- 14 - Blind Mating System for 0.120 [3.05] thick panel.

NOTE: Once you have made a connector selection, contact Technical Sales if you would like to receive a drawing in DXF, PDF format or a 3-dimensional IGES file.

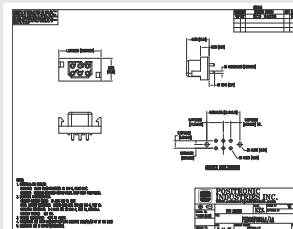

SK Drawing

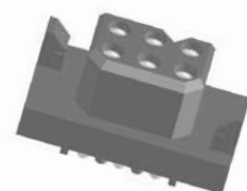

3-dimensional model

* For high conductivity contact connectors, order **PL*H** connectors and *C112N(2)S contacts

** PLB20 variant available with code 2, 3, 32, 4, 42, 92, and 93 only in Step 4.

*** Mounting screws are ordered separately. See page 63 for part numbers.

26 DIMENSIONS ARE IN INCHES [MILLIMETERS].
ALL DIMENSIONS ARE SUBJECT TO CHANGE.